

RIGHT ANGLE PLUG SOLDER TYPE

R187.710.200

CABLE SHF 5LI

Series : 7/16
COMPOSITE

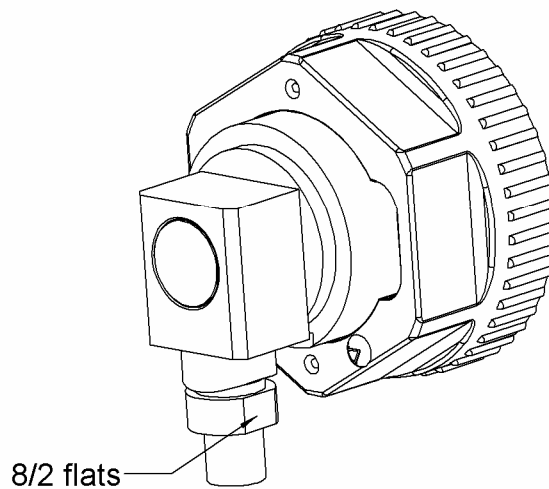
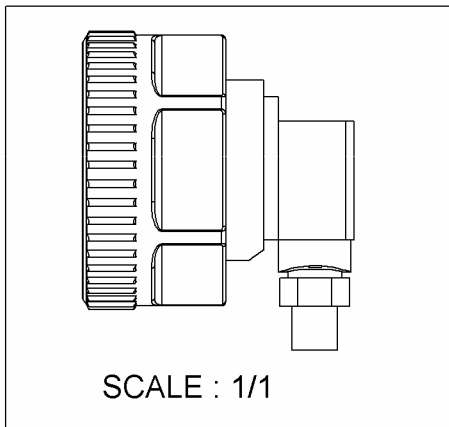
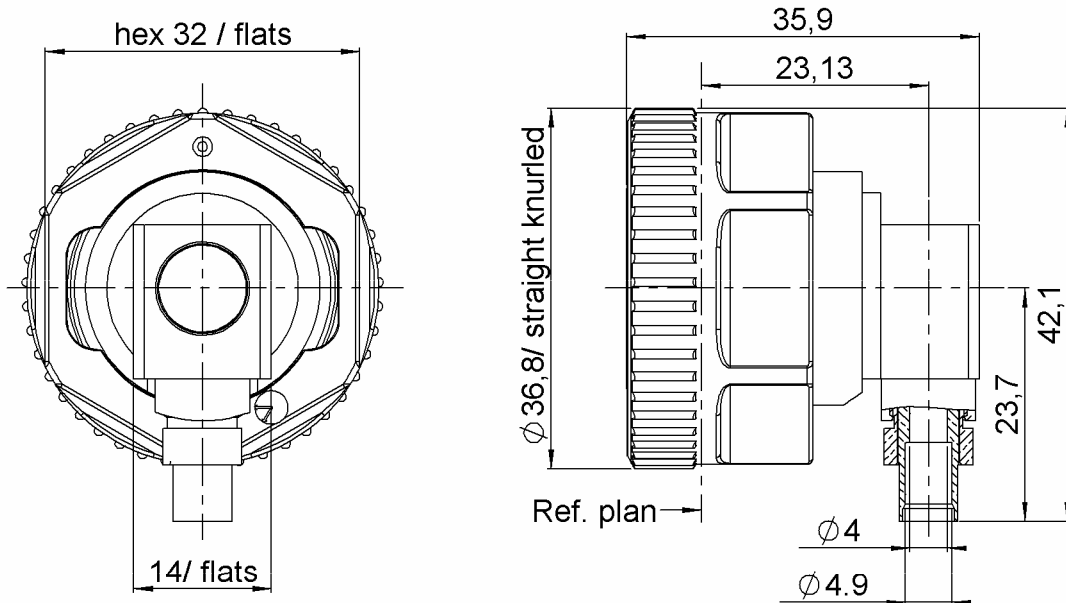

All dimensions are in mm.

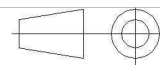

COMPONENTS	MATERIALS	PLATING (µm)
BODY	BRASS	BBR 0.5 OVER SILVER 3
CENTER CONTACT	BRASS	SILVER 5 OVER COPPER 0.5
OUTER CONTACT	BRASS	BBR 0.5 OVER SILVER 3
INSULATOR	PTFE	
GASKET	SILICONE RUBBER	
OTHERS PARTS	COMPOSITE MATERIAL - BLACK	
-	-	-
-	-	-

Issue : 0942 A

In the effort to improve our products, we reserve the right to make changes judged to be necessary.



RIGHT ANGLE PLUG SOLDER TYPE

R187.710.200

CABLE SHF 5LI

Series : 7/16
COMPOSITE

PACKAGING

Standard	Unit	Other
20	'W' option	Contact us

SPECIFICATION

ELECTRICAL CHARACTERISTICS

Impedance	50	Ω
Frequency	0-7.5	GHz
VSWR	* + 0,0000	x F(GHz) Maxi
Insertion loss	0.05	\sqrt{F} (GHz) dB Maxi
RF leakage	- (NA	- F(GHz)) dB Maxi
Voltage rating	500	Veff Maxi
Dielectric withstanding voltage	1500	Veff mini
Insulation resistance	10000	M Ω mini

CABLE ASSEMBLY

Stripping	a	b	c	d	e	f
mm	10,9	9,00	26,9	0,00	16,0	0,00

Assembly instruction :

Recommended cable(s)
SHF5LI VERT

Characteristics indicated on this data sheet are those that can be achieved with the highest performance cable. Intrinsic limitations of the cable may diminish the performance of the assembly

Cable retention

- pull off	90	N mini
- torque	NA	N.cm

MECHANICAL CHARACTERISTICS

Center contact retention		
Axial force – Mating end	200	N mini
Axial force – Opposite end	100	N mini
Torque	NA	N.cm mini

TOOLING

Part Number	Description	Hexagon
.	.	.

Recommended torque		
Mating	2000	N.cm
Panel nut		N.cm
Clamp nut	220	N.cm
A/F clamp nut	8,0000	mm

Mating life (with composite)	50	Cycles mini
Mating life (with brass)	100	Cycles mini
Weight	79,8500	g

OTHER CHARACTERISTICS

*VSWR: 1.15 between DC to 3GHz
*VSWR: 1.35 between 3 to 6GHZ
**PIM3 : -110dBm (2 carries of +43dB)
Interface ingress protection : IP67

ENVIRONMENTAL

Operating temperature	-40/+85	$^{\circ}$ C
Hermetic seal	NA	Atm.cm3/s
Panel leakage	NA	

Issue : 0942 A

In the effort to improve our products, we reserve the right to make changes judged to be necessary.



RIGHT ANGLE PLUG SOLDER TYPE

R187.710.200

CABLE SHF 5LI

Series : 7/16
COMPOSITE

COMPONENTS

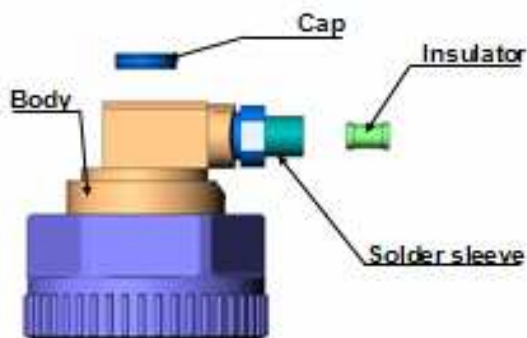

STRIPPING DIMENSIONS

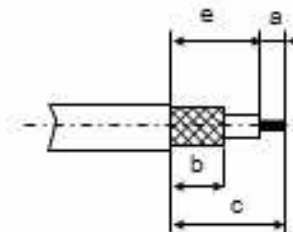

1

Strip the cable.



3

Slide this assembly (cable + insulator) into the connector until braid stops against connector body and you can see the inner conductor in position. Solder the inner conductor and the braid.

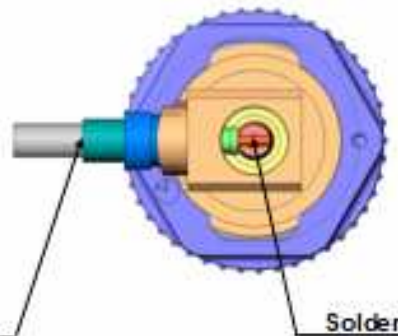

2

Slide the insulator over the inner conductor until it bottoms against cable dielectric.

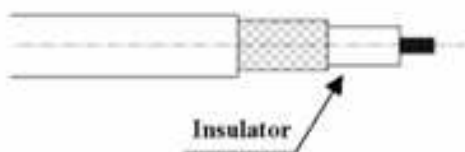

4

Press on the cap flush or slightly below the surface of the body assembly



Issue : 0942 A

In the effort to improve our products, we reserve the right to make changes judged to be necessary.